

# QuantiCheck®

## Quick start guide

### 1 Charging your QuantiCheck®

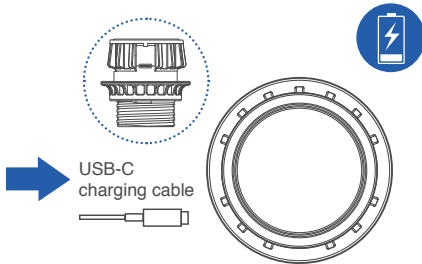

Ensure your QuantiCheck® is fully charged before use. Charging can be done via the USB-C port on the side of the device.

\*Always use USB-C cable supplied

### 2 Attach optional LED extender

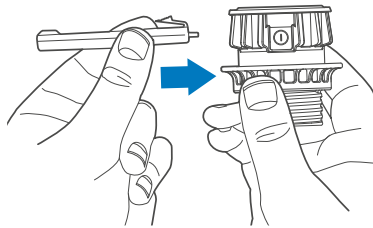

Attach the optional LED extender into the USB-C port if the light on the device is not visible for indication.

### 3 Turn on QuantiCheck® device

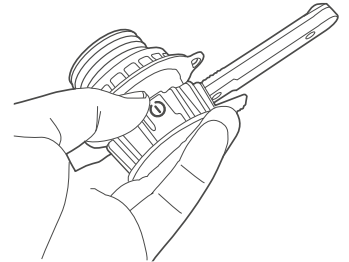

Press and hold power button until green light flashes then release.

### 4 Attach QuantiCheck® device



Attach QuantiCheck® on to the mask.

### 5 Don mask



Don your mask and tighten the appropriate straps.

### 6 Perform fit check

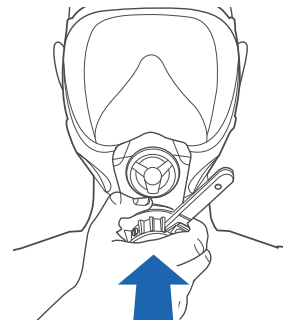

Squeeze or press and hold QuantiCheck® to perform a check. Draw a breath until the blinking purple light turns solid, then hold your breath static for up to 10 seconds and wait for result.

### 7 LED indicator - Pass

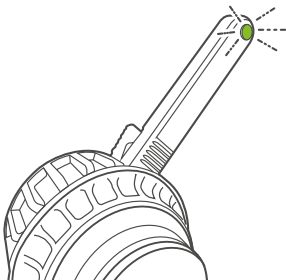

A green light illuminates on the LED indicator for a passed test

### 8 LED indicator - Over breath

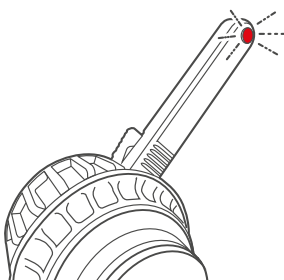

Rapid flashing purple light indicates over breath. Wait a few seconds for purple light to blink slowly. Try again but with a shallower breath.

### 8.1 LED indicator - Fail

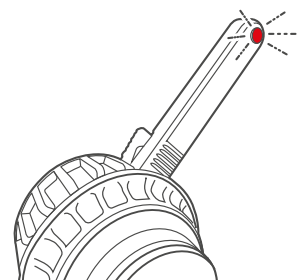

A red light blinking on the LED indicator for a failed check. Wait until the LED indicator flashes purple signalling a retest for the fit check.

# Using the QuantiCheck® mobile app

## 1 Connect to your PC

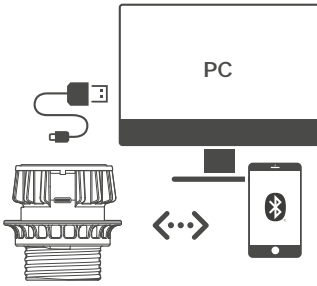

Connect your QuantiCheck® to your PC via the USB port. Alternatively your device can be connected to your smart phone via Bluetooth®.

## 2 Install the QuantiCheck® app

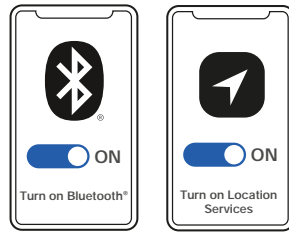

Download and install the QuantiCheck® app on your device. Available for IOS, Android, PC and can be connected wirelessly via Bluetooth®.

## 3 Turn on your QuantiCheck®

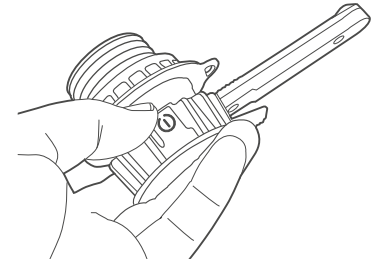

Press and hold power button until green light blinks then release.

## 4 Connect to your device



\*Wait for the app to discover your QuantiCheck® device  
\*On Windows, device needs firstly to be paired to the PC via Bluetooth®.

## 5 Choose user



Under users select "Choose User" and select the user or add new user.

## 6 Don mask and perform a fit check

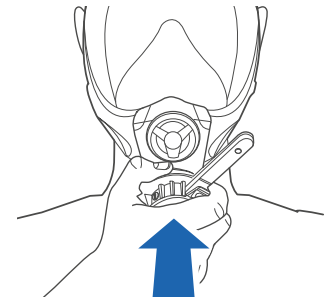

Attach QuantiCheck® to mask and don. To perform a fit check - "see point 6 on how to perform a check."

## 7 Pass or fail indication



A solid green band will display on the app for a passed check or a solid red band for failed check.

## 8 View your results

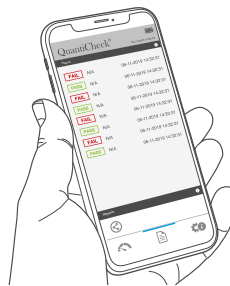

To see the list of results press the 'Reports' icon on the foot of the app.

## 9 Share and download results

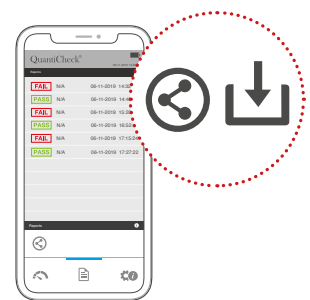

To share or download results locate the relevant icon below the reports and share or download.

## A Passed fit check

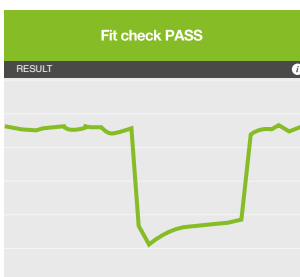

A positive pull fit check trace line shows a single large fluctuation, followed by a gently increasing line before rising again at the end of the fit check upon releasing breath.

## B Damaged or leaking seal

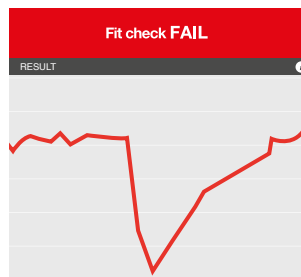

A negative pull fit check trace line shows large fluctuations or drops rapidly when there is a leaky or damaged seal or a poorly fitted mask.

## C User re-breath

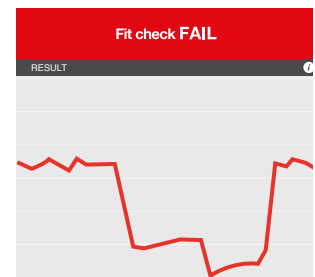

When a subject takes an extra breath mid test, or pushes on the mask increasing the pressure.